



**WEAR BUTTONS/
DONUTS**

PRODUCT DATA SHEET

DRAWING NO: PF-0004-1

REV NO: A

Phone: +1 469-269-2500
Fax: +1 469-200-8821

Web: www.cqmsrazer.com/usa

NOTE

Function

To reduce or eliminate wear in localized areas and in so doing, provide continued production capability to plant and equipment in a cost effective manner.

Features

- Provides up to 6 times the life of conventional wear plates.
- Ideally suited for in situ repairs and/or installation into localized areas of extreme wear.
- 700 Brinell hardness Chrome Moly white iron metallurgically bonded to mild steel provides extreme levels of both abrasion and impact resistance.

Benefits

- Most popular for replacing hard facing and clad plate.
- Used for almost any application where abrasive wear is causing lost production through machine down time.

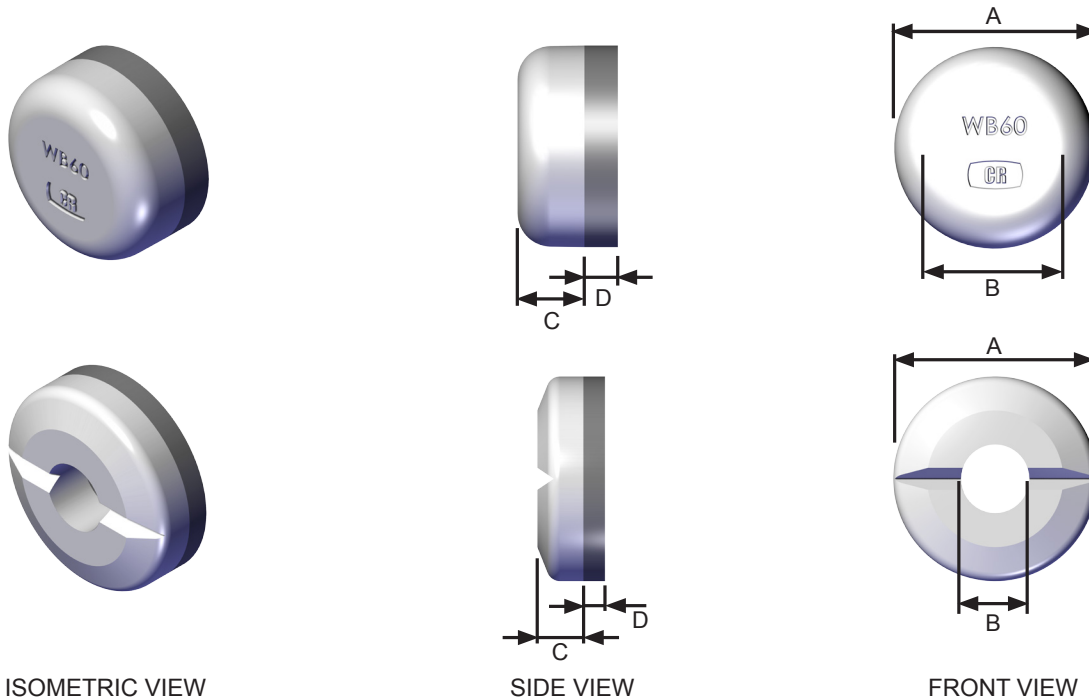

ISOMETRIC VIEW

SIDE VIEW

FRONT VIEW

PART No.	DIMENSIONS in/mm				DESCRIPTION	MASS (lbs/kg)
	A	B	C	D		
WB60	2.36/ 60	1.57/ 40	0.79/ 20	0.4/ 10	WEAR BUTTON	2.2/ 1
WB75	2.95/ 75	2.17/ 55	0.79/ 20	0.4/ 10	WEAR BUTTON	2.2/ 1
WB90	3.54/ 90	2.76/ 70	0.79/ 20	0.4/ 10	WEAR BUTTON	2.2/ 1
WB115	4.53/ 115	3.74/ 95	0.79/ 20	0.47/ 12	WEAR BUTTON	4.4/ 2
WB150	5.9/ 150	5.08/ 129	0.2/ 25	0.63/ 16	WEAR BUTTON	11/ 5
DLP1920	2.95/ 75	1/ 25	0.67/ 17	0.31/ 8	WEAR DONUT	2.2/ 1
DLP1921	3.94/ 100	2/ 50	0.67/ 17	0.31/ 8	WEAR DONUT	2.2/ 1
DLP1994	3.94/ 100	2.76/ 70	0.94/ 24	0.31/ 8	WEAR DONUT	2.2/ 1
DLP2196	5.12/ 130	3.15/ 80	0.9/ 23	0.31/ 8	WEAR DONUT	4.4/ 2